

ELGA

ELECTRICAL DISTRIBUTION EQUIPMENT

**NEW compact RANGE
12 kV METAL - ENCLOSED TYPE
SWITCHGEAR**

USN-10/120 Compact

MAIN CHARACTERISTICS

Type tested according IEC 62271-200

Construction of three high voltage compartments with draw-out circuit breaker

New design make-type earthing switch with dead point free mechanism

One side maintenance

Complete air insulation of all switchboard live parts

IP4X degree of protection on the external housing

Constructed to withstand the overpressures caused by the internal arc 25kA/1s

Busbar segregation shutters activated by circuit breaker movement inside the compartment to reach LSC2B category.

HV doors mechanical interlocks ensures safe maintenance

Very small overall dimensions (630A/1250A feeder width – 550mm, 1600A/2000A feeder width – 750mm, height - 2050 mm, system depth – 1200mm)

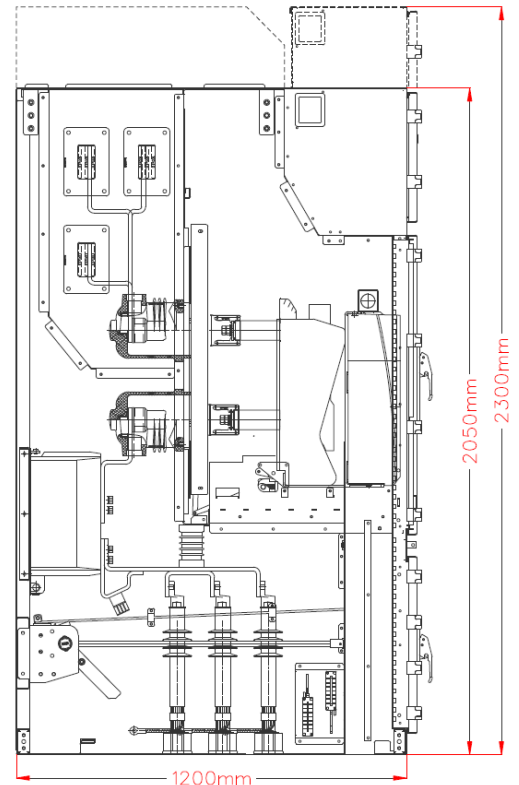

TECHNICAL DATA

Rated operating voltage	U, kV	12
Test voltage (50-60) Hz, 1 min	$U_{(1 \text{ min})}$, kV	28 (42)
Impulse withstand voltage (1,2-50) μ s	U, kV	75
Rated main busbar current	I_n , A	630...2000
Rated short time withstand current	$I_{cw(3s)}$, kA	16; 20; 25
Peak current	I_{cm} , kA	40; 50; 63
Loss of service continuity category (IEC 62271-200)		LSC2B

SIMPLE AND SOLID DESIGN

SION (Siemens) or VD4 (ABB) vacuum circuit- breakers on draw-out element (cassette type)

The torsionally rigid housing with high corrosion resistance based on Aluzink

Extremely compact design suitable for retrofitting old switchgears

Simple inspection and maintenance, thanks to easy access to the apparatus in the various compartments through doors or easily removable panels and the possibility of isolating and removing the circuit breaker

MAIN SWITCHGEAR CUBICLE TYPES

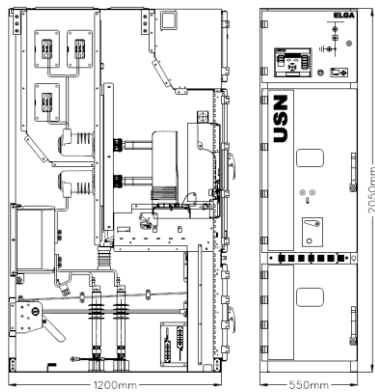

630A/1250A circuit breaker cubicle

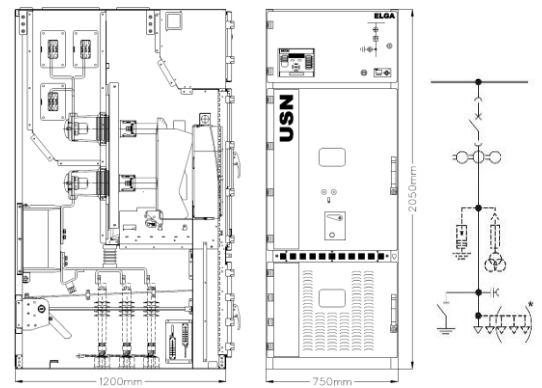

1600A/2000A circuit breaker cubicle

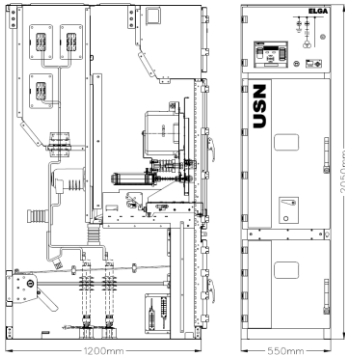

Voltage transformer (bus riser) cubicle

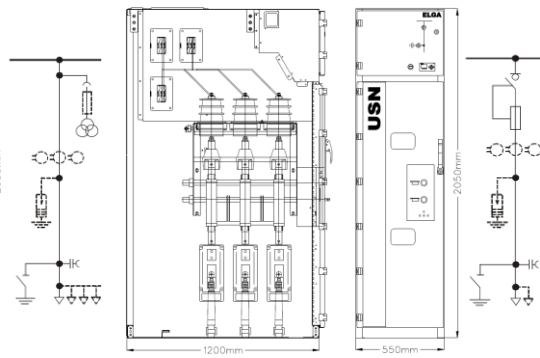

Load break switch cubicle

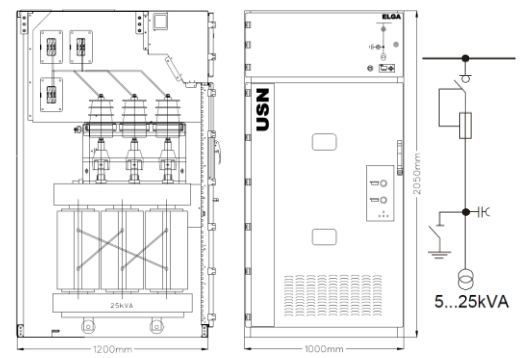

Service transformer cubicle

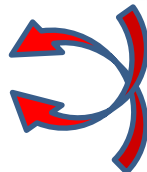
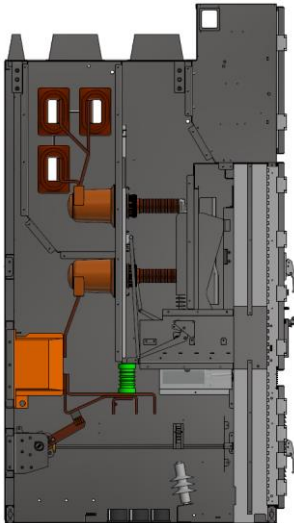

CIRCUIT BREAKERS

Cubicles are equipped with SION (Siemens) or VD4 (ABB) vacuum circuit breakers (choice of the customer).

Main circuit breaker characteristics:

- Draw-out version with front operated mechanism
- Operating mechanism with charged spring operated drive
- Maintenance free with 10 000 mechanical operations
- Full remote control including truck and earthing switch motor mechanisms
- Top quality vacuum interrupters

ELGAUAB

Pramones st. 12
 LT-78150 Siauliai, Lithuania
 Tel.: +370 41 594710
 Fax.: +370 41 594725
 E-mail: info@elga.lt
 Internet: www.elga.lt

